

INSTRUCTION MANUAL

PACIFICA FA0122BL

I. Installation Notice

1. Install water supply lines in accordance with this manual.
2. Floor drain should be installed in the location of the faucet.
3. Install exposed parts except valve bodies only after the completion of house interior decoration in case paint or other chemicals erode faucet surface. Before this, keep valve bodies covered with protection sheath.
4. Clean pipes before installation to get rid of mud, sand or other debris.
5. If the thread of pipes don't match well with product, please find out the reason first, otherwise a forced connection will damage the faucet.
6. After installation, ensure all the joints are firmly connected. Then run water and open faucet repeatedly to make sure there are no leaks. At this stage, the product is ready for normal use.
7. Keep the manual to the user.

II. Operation Notice

1. The working condition of this product is water pressure 0.05~1.0MPa, water temperature 4~90°C.
2. Do not hang heavy things on the faucet.
3. Make sure the faucet is off when no water comes out of it (especially when nobody resides in or during the period of decoration or suspend of water).
4. Regularly clean the surface of faucet to keep it bright. Attention: do not use inappropriate tools such as sharp brushes, rough sponges, scouring pads or corrosive detergent to clean the faucet, and we do not recommend that you use the detergent sold in the market, because its formula is changing frequently. Please clean the faucet by a wet cotton cloth with soapy water, then rinse and dry with a soft cotton cloth after each time of usage.
5. When the room temperature drops to below 0°C, take necessary measures (such as keeping faucet warm and closing windows) to prevent the faucet from being frozen or even broken (especially when windows kept open for air ventilation while nobody resides in).
6. Please open the cold and hot water in turn and adjust to comfortable temperature before washing to avoid scald.
7. Do not disassemble the product unless you are an expert.

III. Installation Diagram

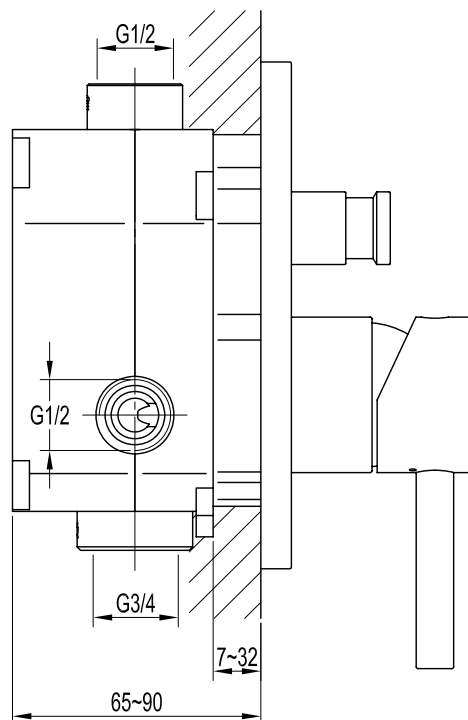

* The installation diagram is only for reference, the product is subject to the real object.

IV. Installation Steps (Fig.1- 17)

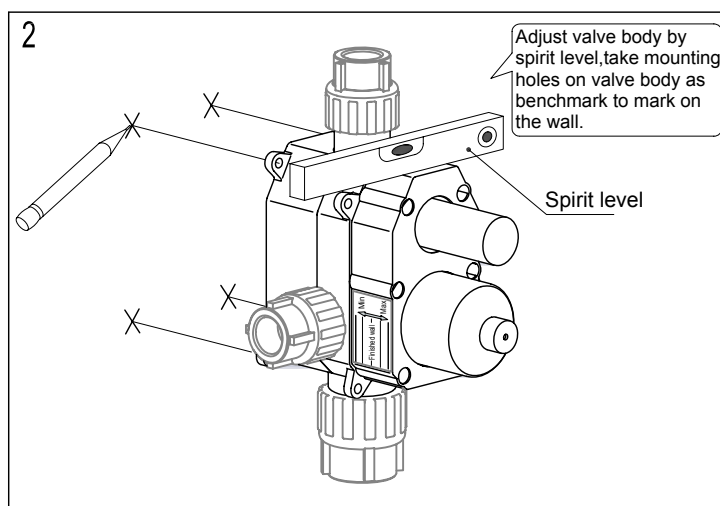
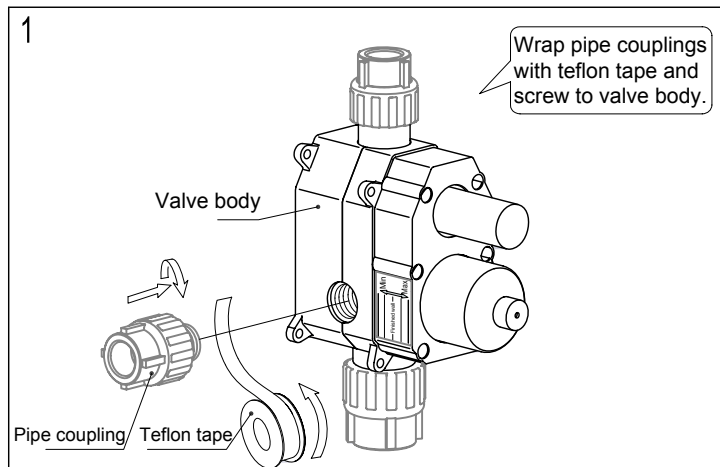

3

Drill 4pcs $\varnothing 8$ holes at mark position.

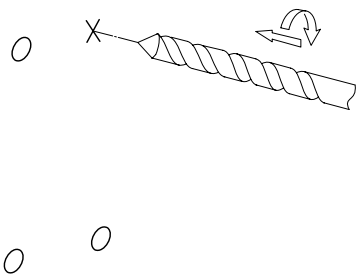

7

Flow water to get rid of dirt in pipes.

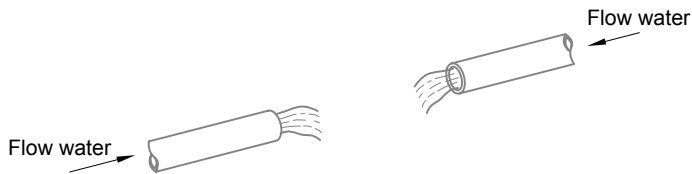

4

Insert anchors to $\varnothing 8$ holes, slightly fix valve body on the wall with self-tapping screw.

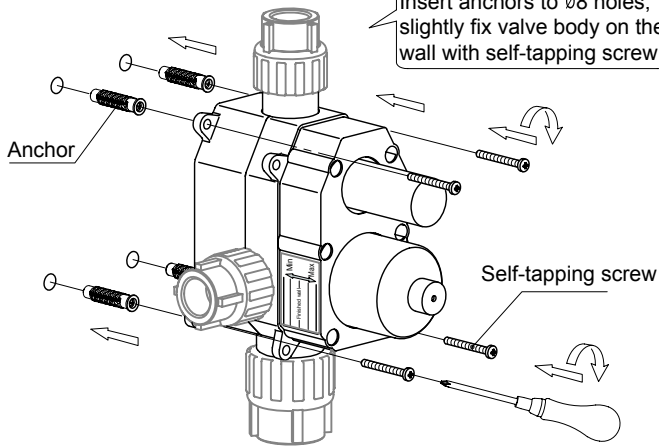

8

Connect inlet and outlet pipes, plug up the outlets with plugs (Note: inlet pipes should be hot left and cold right).

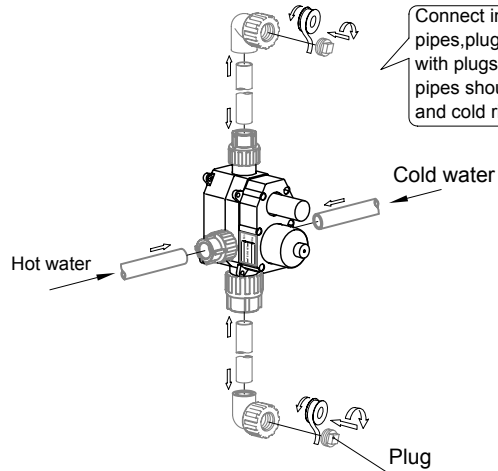

5

Adjust valve body by spirit level, fix with self-tapping screw.

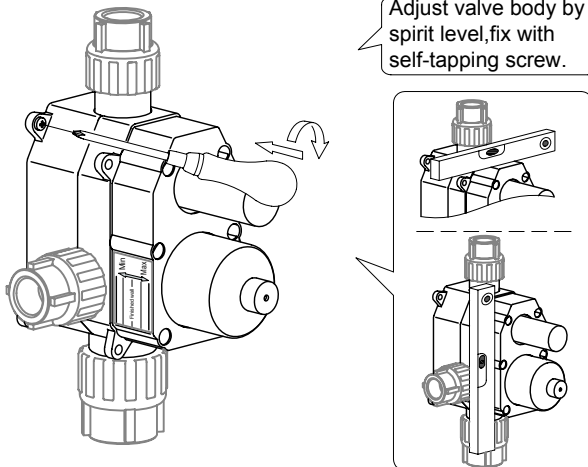

9

Take off protection sheath.

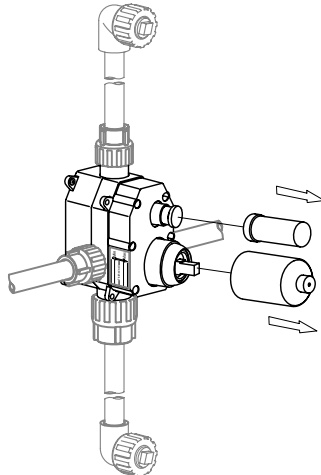

6

Also can install valve body on shower board.

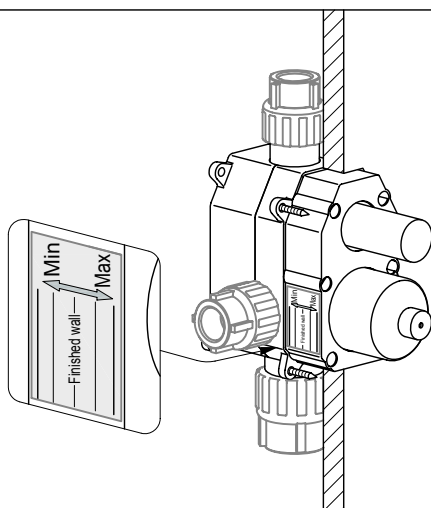

10

Run water for pressure test.

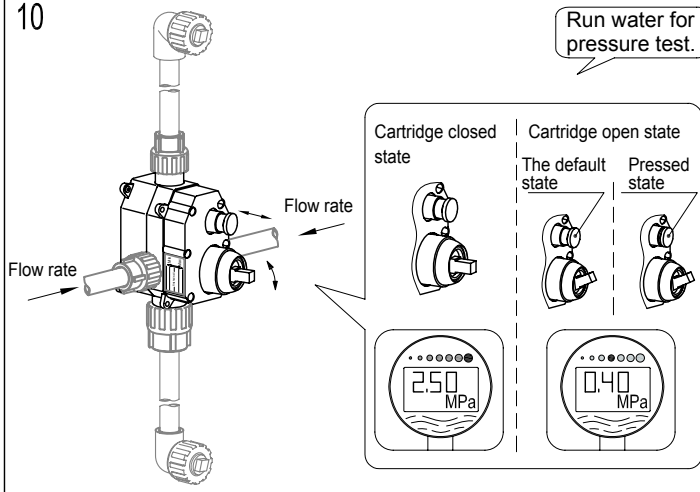

11

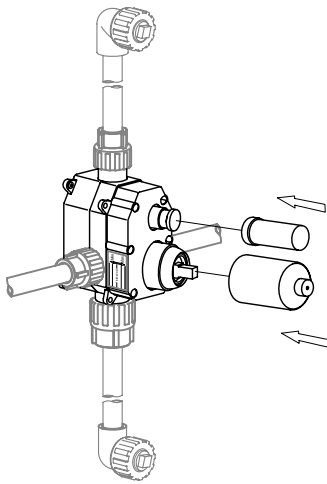

Put on protection sheath.

15

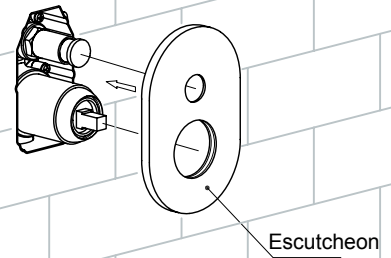

Put on escutcheon.

Escutcheon

12

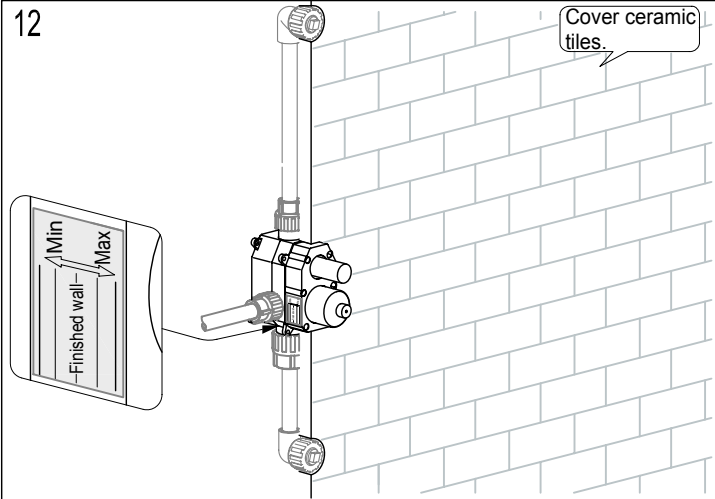

Cover ceramic tiles.

16

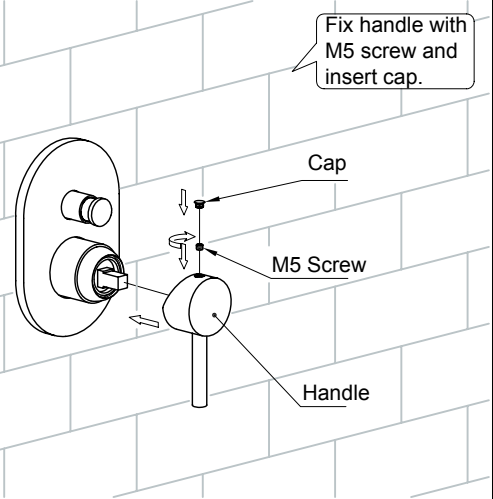

Fix handle with M5 screw and insert cap.

Cap

M5 Screw

Handle

13

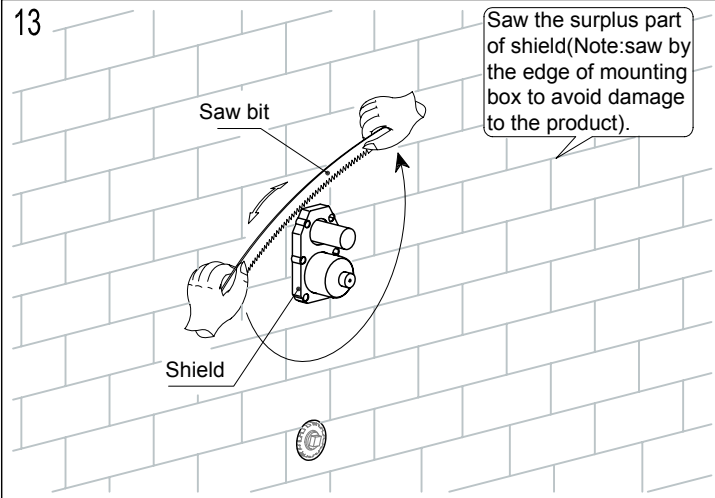

Saw the surplus part of shield (Note: saw by the edge of mounting box to avoid damage to the product).

17

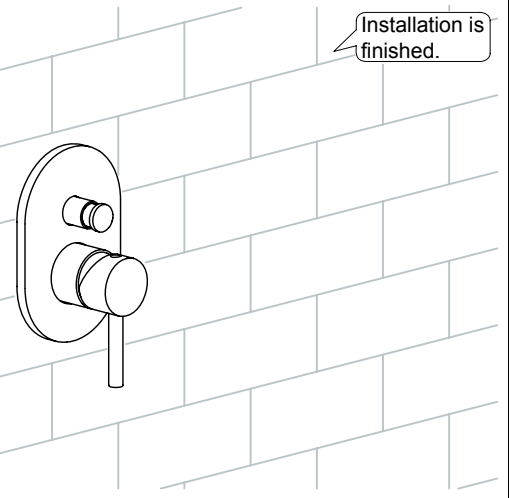

Installation is finished.

14

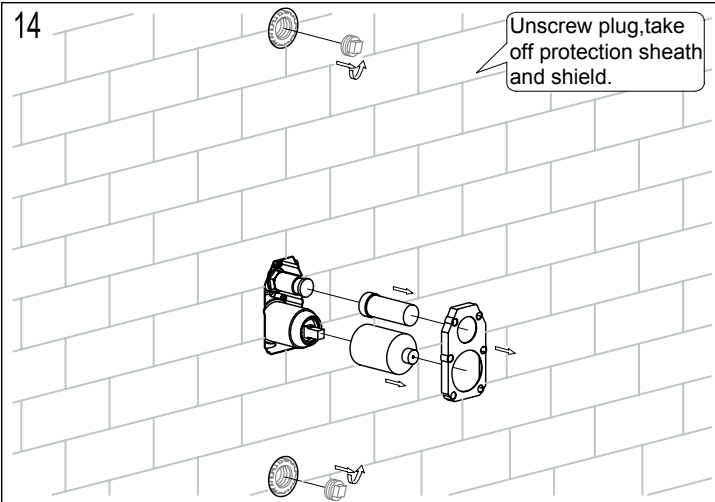

Unscrew plug, take off protection sheath and shield.