

INSTRUCTION MANUAL

SUTRO FA0331CP

I. Installation Notice

1. Install water pipes in accordance with this manual.
2. Floor drain should be installed in the location of the faucet.
3. Rough-in box should be installed before ground construction. The associated mixer should be installed after the ground construction. The rough-in box on the inlet base shall not be cut or removed, and shall be protected to avoid damage to each rough-in box and inlet base during construction.
4. Clean pipes before installation to get rid of mud, sand or other debris.
5. If the thread of pipes don't match well with product, please find out the reason first, otherwise a forced connection will damage the faucet.
6. After installation, check all the joints to ensure they are firmly connected. Then keep water flow. Turn on and off repeatedly to ensure there is no leakage around the joints. At this stage, the product is ready for normal use.
7. Keep the manual to the user.

II. Operation Notice

1. The working condition of this product is water pressure 0.05~1.0MPa, water temperature 4~90°C.
2. Do not hang heavy things on the faucet.
3. Make sure the faucet is off when no water comes out of it, especially when nobody resides in or during the period of decoration or suspend of water.
4. Regularly clean the surface of faucet to keep it bright. Attention: do not use inappropriate tools such as sharp brushes, rough sponges, scouring pads or corrosive detergent to clean the faucet. It is not recommended to use the detergent sold in the market, because its formula changes frequently. Please clean the faucet by a wet cotton cloth with soapy water, then rinse and dry with a soft cotton cloth after each time of usage.
5. When the room temperature drops to below 0°C, take necessary measures (such as keeping faucet warm and closing windows) to prevent the faucet from being frozen or even broken (especially when windows kept open for air ventilation while nobody resides in).
6. Please open the cold and hot water in turn and adjust to comfortable temperature before use to avoid scald.
7. Do not disassemble the product without the help from the professionals.

III. Installation Steps(Fig.1-8) :

* The installation diagram is only for reference. The product is subject to the real object.

Mark position based on the mounting holes of the rough-in base and drill holes. Wrap the coupling with Teflon tape and connect it to the rough-in base. Then connect feeding pipes of proper length. Install four expansion bolts into the rough-in base and tighten hex nuts. Adjust M8 screws on the rough-in base to its level position and then tighten hex nuts. (Attention that the hot water inlet face towards the bath.) Run water to get rid of any debris inside pipes. Connect feeding pipes.

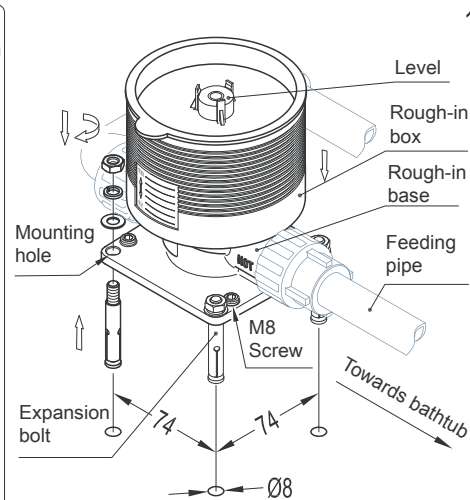

2

Remove the cover and run water for pressure test. Check all joints to make sure no leakage. Then put back the cover.

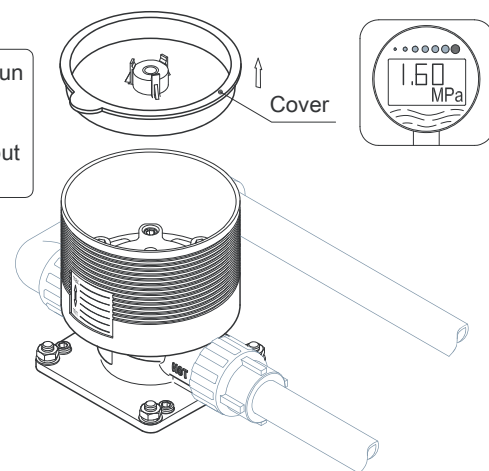

For floor work, make sure the center of inlet pipes to finished floor is between 28-50mm.

Reference of finished floor

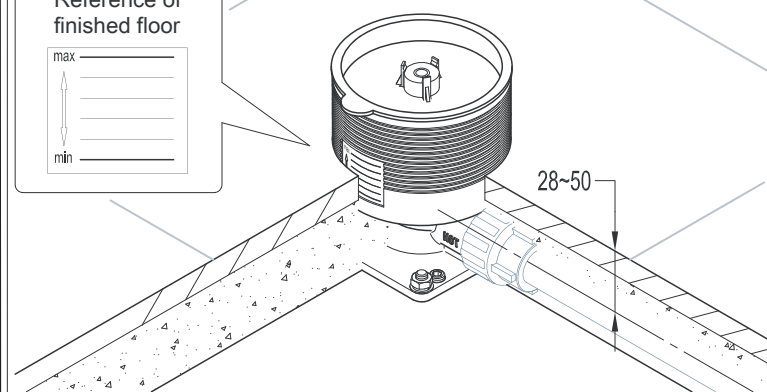
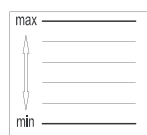

4

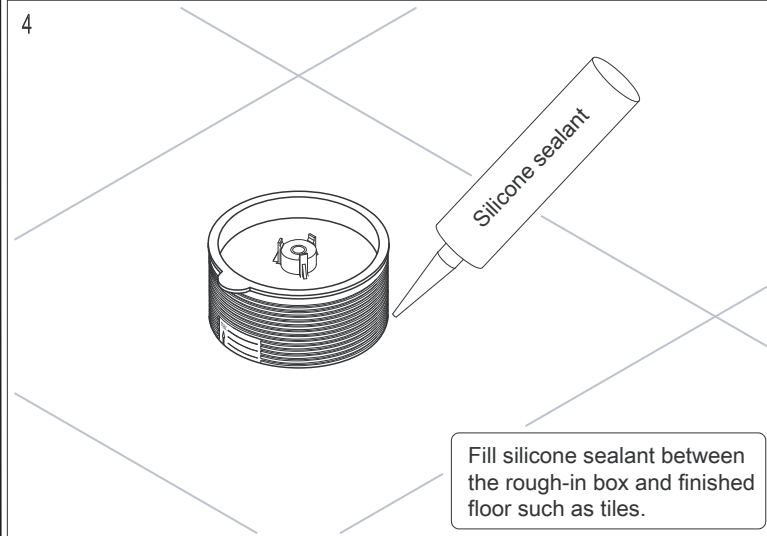

5

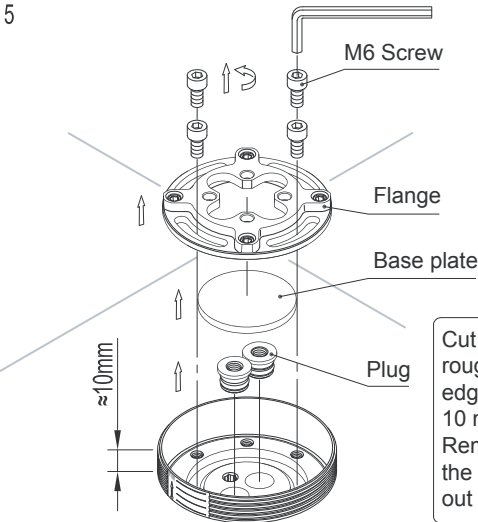

Cut off the excessive part of the rough-in box. Keep the top edge of the rough-in box about 10 mm above the finished floor. Remove M6 screws, take out the flange and base plate, pull out the plugs.

8

After installation, flush water to check if the installation is proper. (If the hot and cold feeding pipe is found to be connected in reverse after installation, use S6 wrench to turn the inner core 180° to make the cold and hot water reverse connection.)

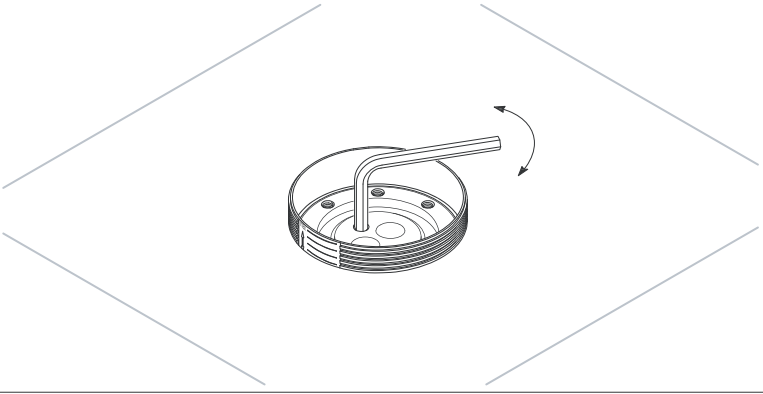

6

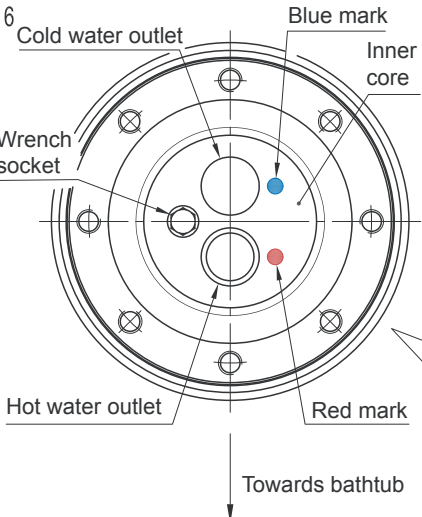

Make sure the inner core is at the position as shown in the diagram. The position of hot and cold water inlets need to align with. The hot water outlet faces against the bathtub.

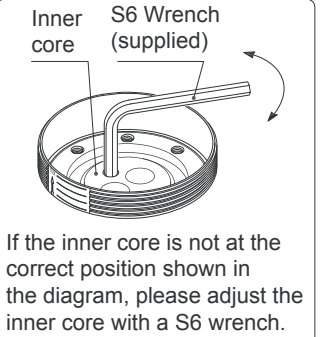

If the inner core is not at the correct position shown in the diagram, please adjust the inner core with a S6 wrench.

7

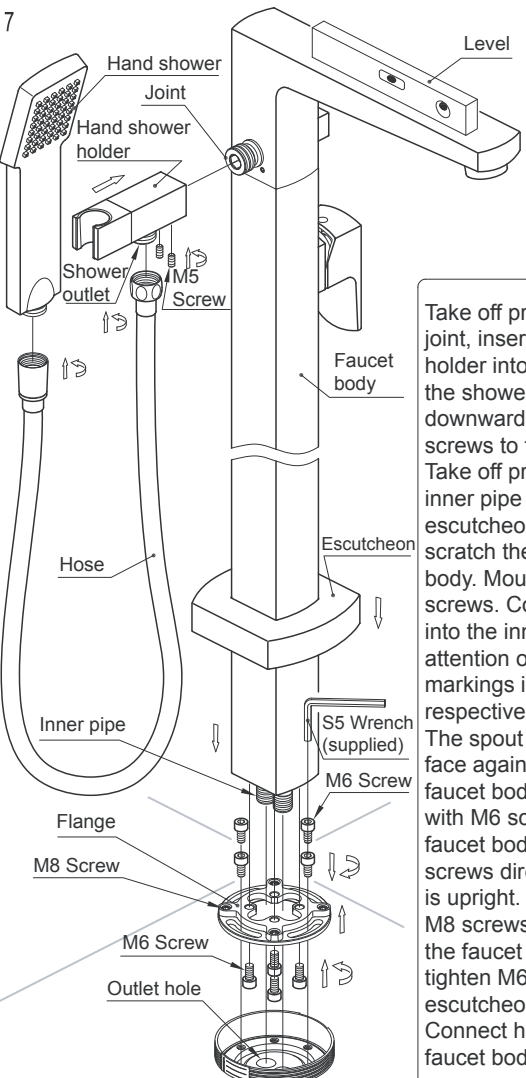

Take off protection sheath off the joint, insert the hand shower holder into the faucet body with the shower outlet facing downwards, then tighten the M5 screws to faucet body firmly. Take off protection sheath from inner pipe of faucet body, put on escutcheon. Be careful not to scratch the surface of faucet body. Mount the flange using M6 screws. Connect the inlet pipe into the inner core vertically with attention of red and blue markings indicating hot and cold respectively. The spout of the faucet should face against the bathtub. Fix the faucet body on the rough-in base with M6 screws. Adjust the faucet body by level. Tighten M6 screws directly if the faucet body is upright. Otherwise, adjust the M8 screws on the flange until the faucet body is upright, then tighten M6 screws. Press the escutcheon down on the floor. Connect hand shower and faucet body with hose.